

## Fairfield Road, London, E3 2UB

Generous Studio Apartment in ever so popular Bow Quarter. The property boasts a naturally bright living room/bedroom, modern kitchen, a stylish bathroom. It comes with an allocated parking space and is located a short stroll from Bow Church DLR and Bow Road underground stations for an easy commute to the City, Canary Wharf and the West End. Onsite benefits include a 24hr concierge service, access to the gym & leisure centre with swimming pool, jacuzzi, sauna and steam room, bicycle storages as well as a grocery shop.

- 24 Hour Concierge
- Landscaped Communal Grounds
- Swimming Pool & Gym
- Gated Development
- Close to Amenities

**Alex & Matteo**  
ESTATE AGENTS

**£1,600 Per month**

# Arlington Building, Fairfield Road

Approx. Gross Internal Area 318 Sq Ft - 29.54 Sq M

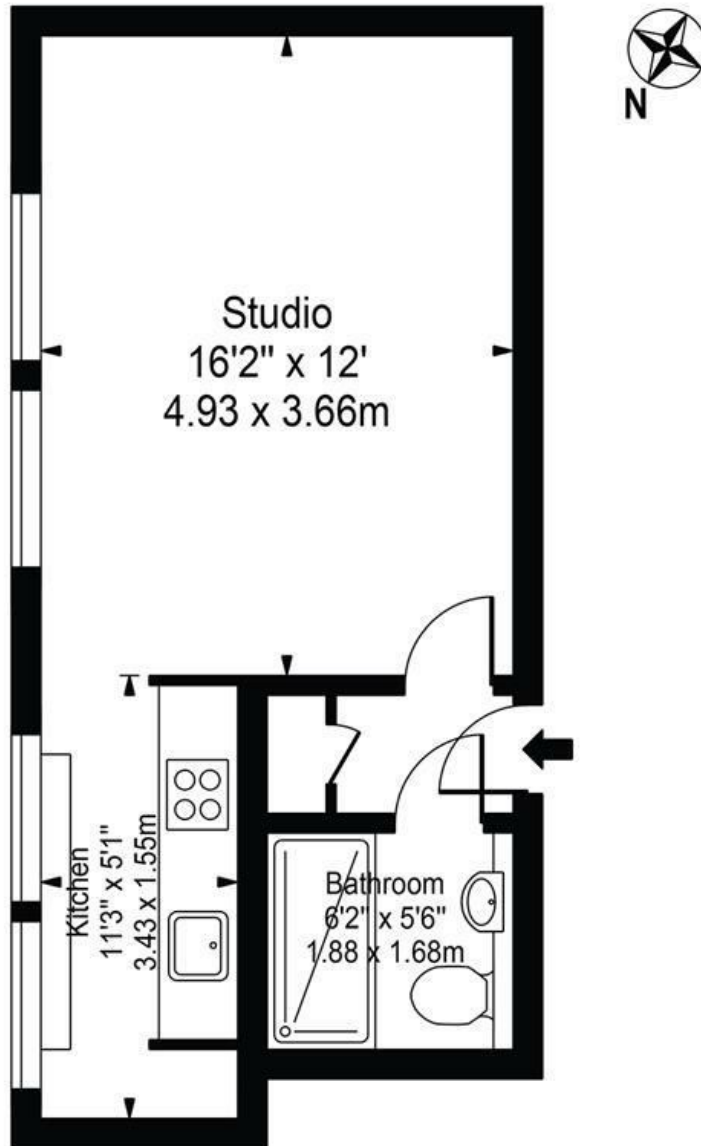

## First Floor

For Illustration Purposes Only - Not To Scale

This floor plan should be used as a general outline for guidance only and does not constitute in whole or in part an offer or contract. Any intending purchaser or lessee should satisfy themselves by inspection, searches, enquiries and full survey as to the correctness of each statement. Any areas, measurements or distances quoted are approximate and should not be used to value a property or be the basis of any sale or let.

